

# Raman Cultural Musuem

## Phrapradeang District, Samutra Prakarn.

For 200 years that The Mons immigrated to Siam because of Civil War in Burma. They Settled down in Districts where Thai Royal Court prepare for them. Phra - Pradeang District is one of large Mon Communities. The Culture is sending through generation by generation but Nowadays, The Mon descendant gradually forget How greatness their ancestor and let their tradition and heritage lost in the time. Raman Cultural Musuem were designed to be the center of Knowledge of Mon people glorify the importance of traditional ways Create a learning process To continue ,apply and maintain them to the future.

### PURPOSE

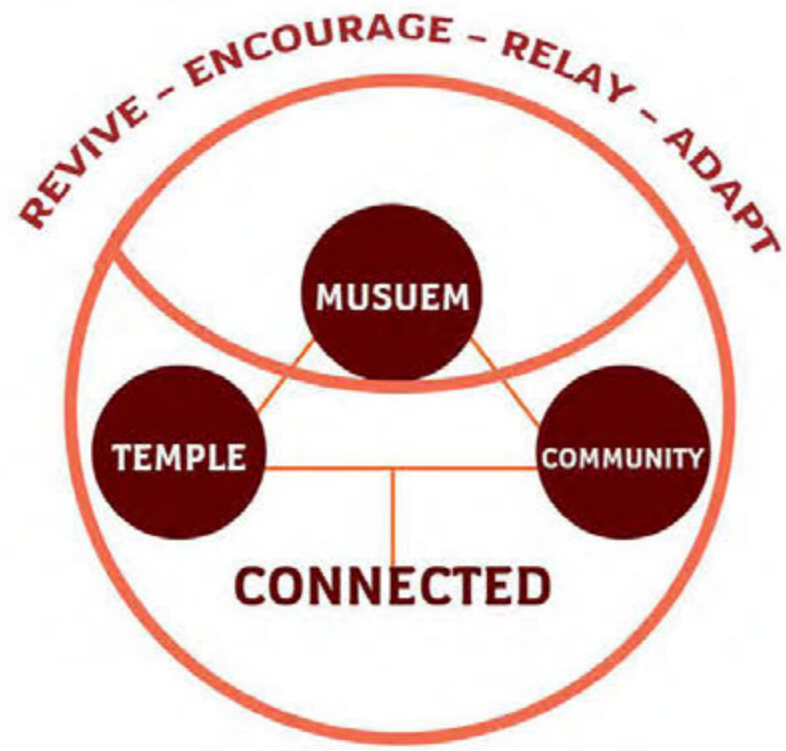

### SITE

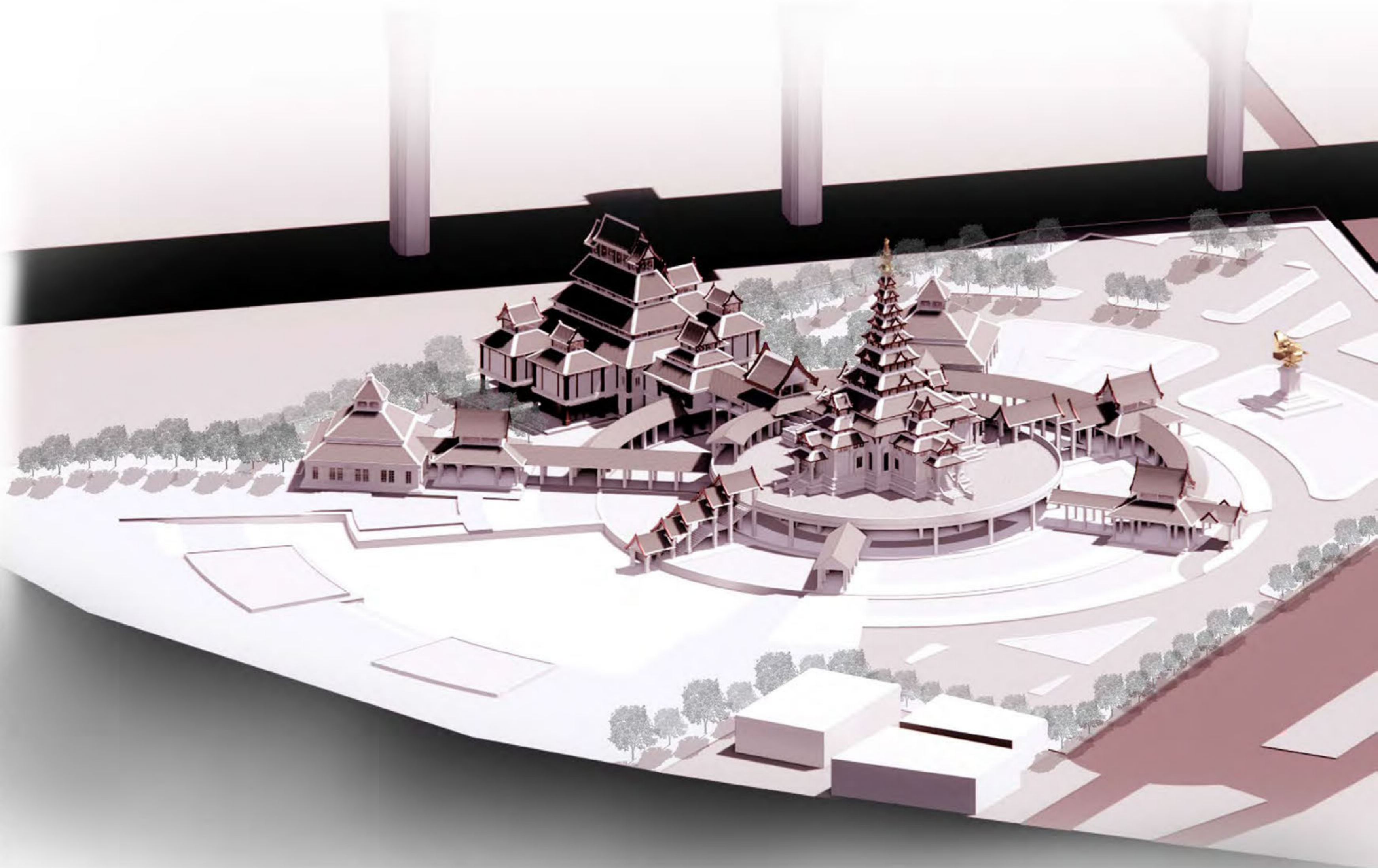
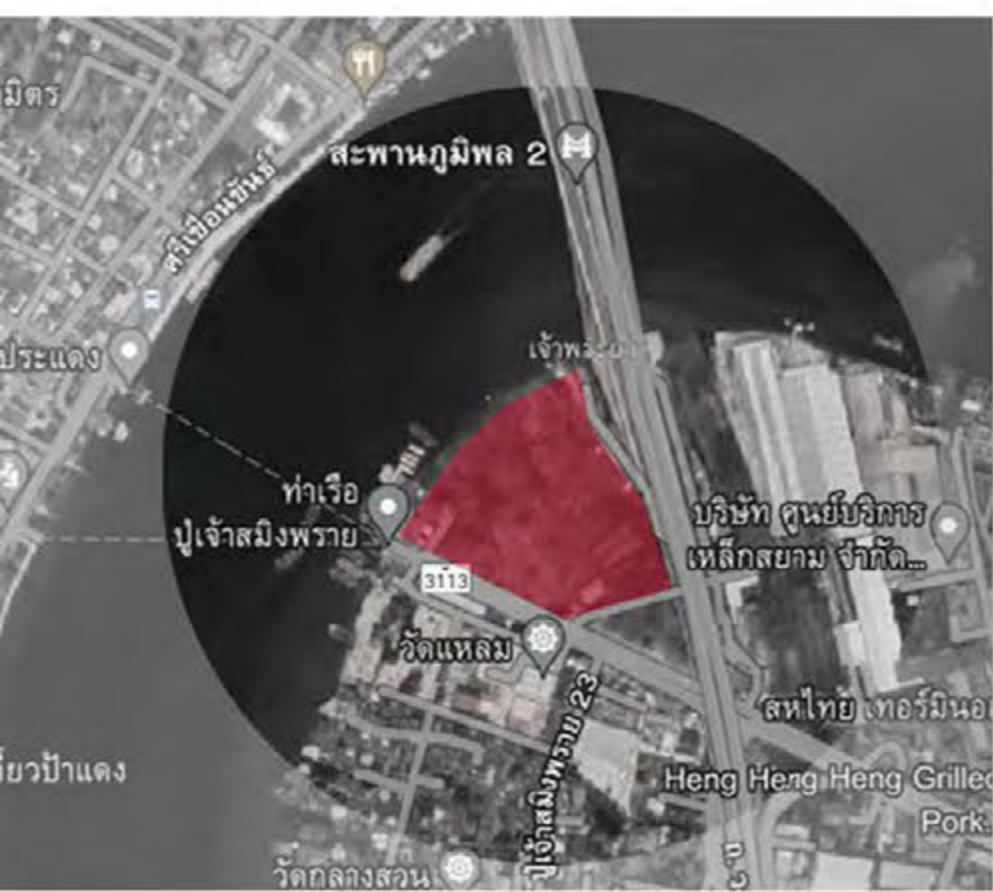

### MONTHAPA BUDDHA RAMAN NAGARA

PLAN

24.317

6.268 2.772 2.133 3.800 2.133 2.772 6.268 2.732

13.610

Design for this project to being The center of Monthapa by the meaning of center of spiritual and belief of Mon people.

Buddha Raman Nagara ,the Prophet

Designing by insprire and adapt from Myanmar-Mon traditional architecture By use A Mix used and Public buddhish building type called Kyaung.

### SITE PLAN

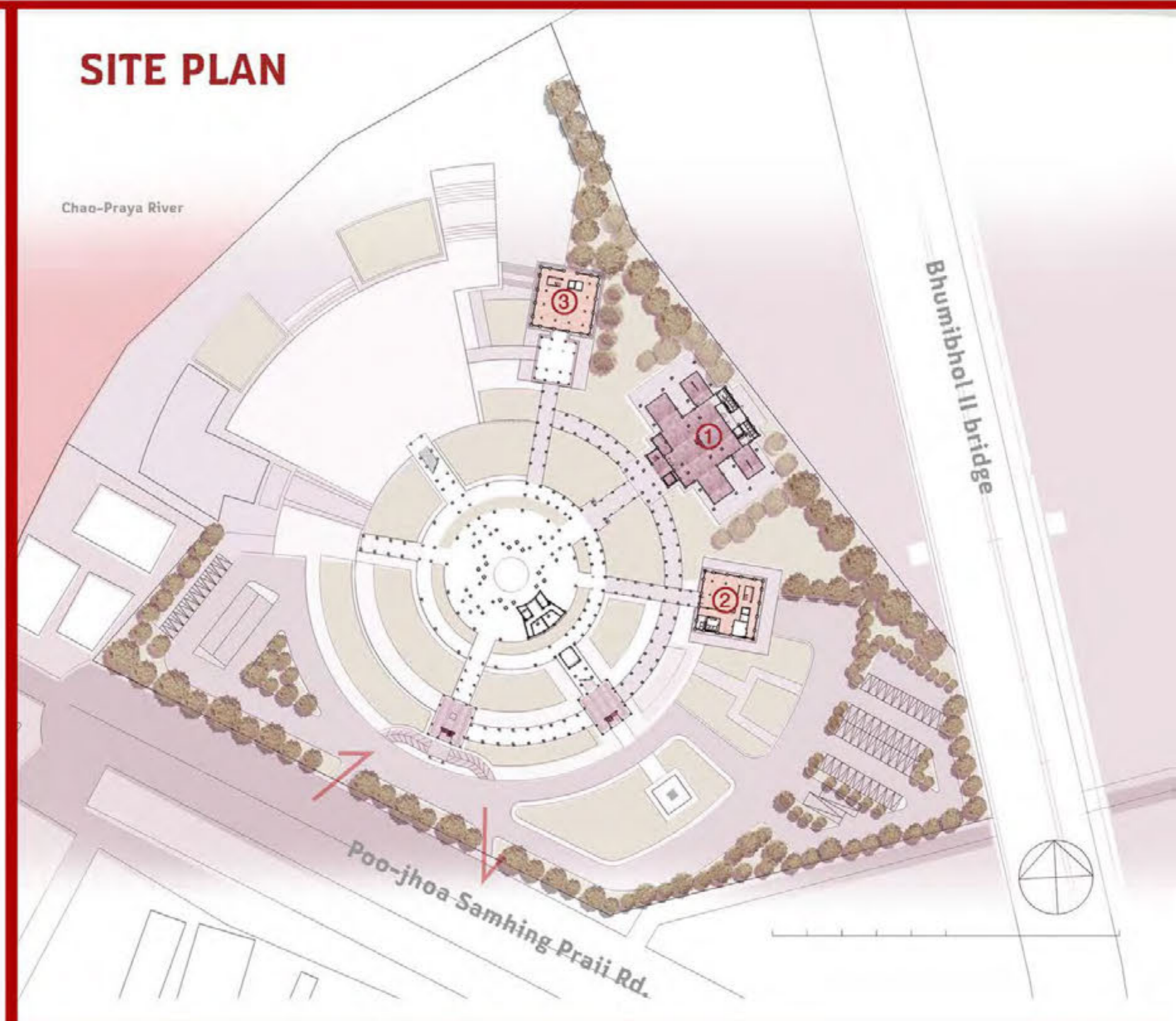

### BUILDING



### PERSPECTIVE

